

- (8) Remove sleeve, spring and bolt from handle.

### Assembly

- (1) Lubricate areas contacted by mechanism.
- (2) Assemble handle loosely with bolt and spring to bracket on back panel.
- (3) Assemble sleeve to handle and tighten handle nut.
- (4) Partially assemble release rod to panel through hole in seat frame right side against stop with lever and bearing.
- (5) Complete rod installation through hole in bracket and insert spring nut onto rod.
- (6) Push rod through hole in seat frame left side against stop.
- (7) Nest bearing into bracket and lever into bearing.
- (8) Secure with set screw.
- (9) Assemble clips to release handle and lever.
- (10) Assemble link to clips after rotating release handle clockwise to engage spring.
- (11) Assemble knob to handle and install screw.

- (12) Install handle bumper on bracket and cover on back panel with screws.

### Cover Material Installation

Prior to installing the original or new cover, make certain the spring pad (where used) and pad cover are centered on the spring and are firmly attached. **Make certain all buttons and medallions (where used) are pulled down securely and locked in position.**

As an aid in attaching the cover correctly, mark the areas on the spring where the original cover was attached with hog rings, screws or drive nails.

### SAFETY BELTS

Refer to Figures 31 through 44 for methods and areas of attaching the safety belts.

### POWER SEATS

Refer to the Electrical Group for tests, wiring diagrams and complete servicing procedures.

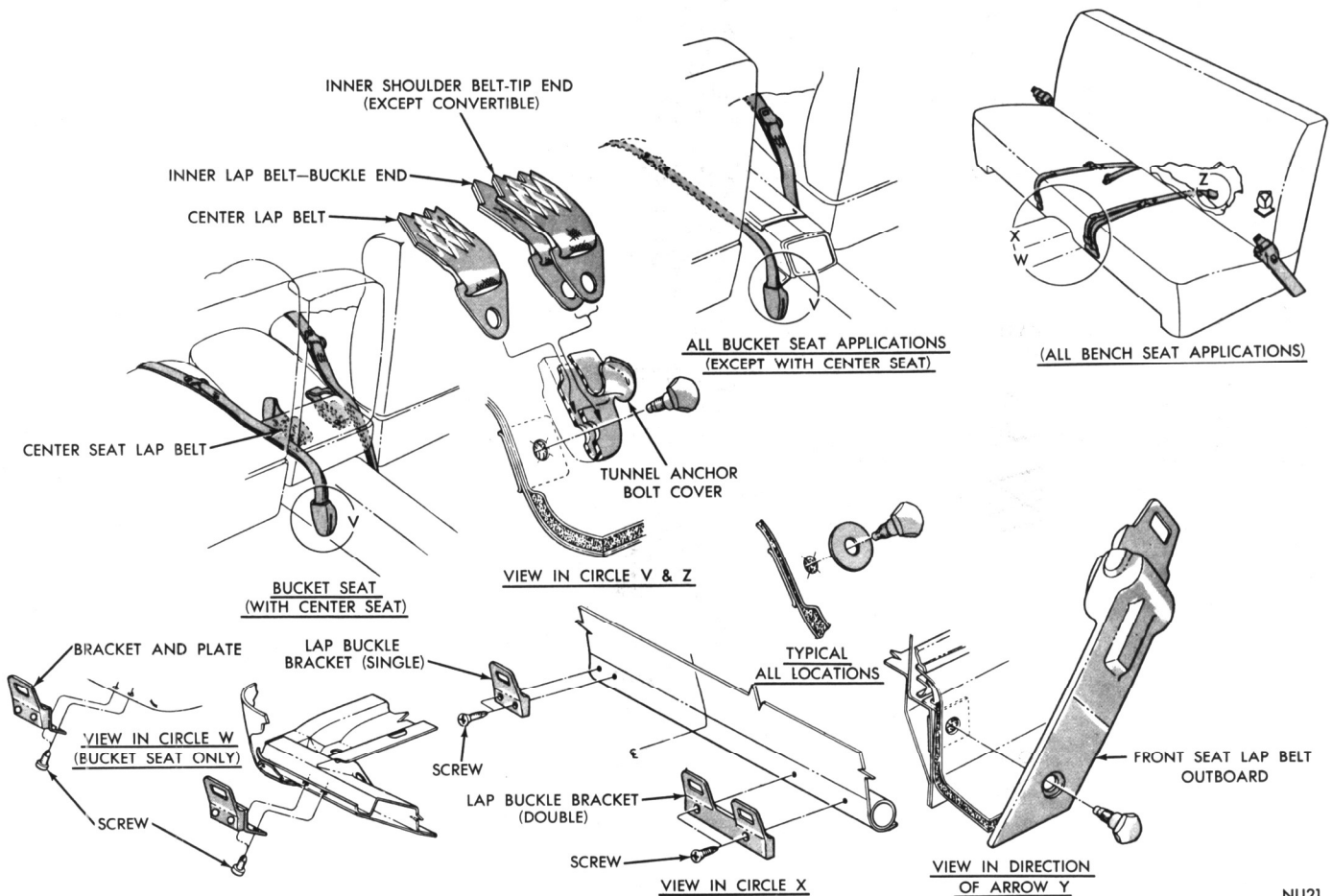

NU21

**Fig. 31—Front Seat Lap Belts—Valiant-Barracuda-Satellite**